

# 香海正覺蓮社佛教陳式宏學校

2021 至 2022 年度

## 以 eClass Parent App 上載快速抗原測試結果指引

1. 更新 eClass Parent app 至最新版本(1.73.2 或以上)



eClass Parent App

版本: 1.73.2

博文教育（亞洲）有限公司

電話 +852 3913 3211

電郵 [parent@eClass.hk](mailto:parent@eClass.hk)

2. 安裝 /更新手機應用程式

安裝 /更新部份 (Android)



## 安裝 /更新部份 (iOS)

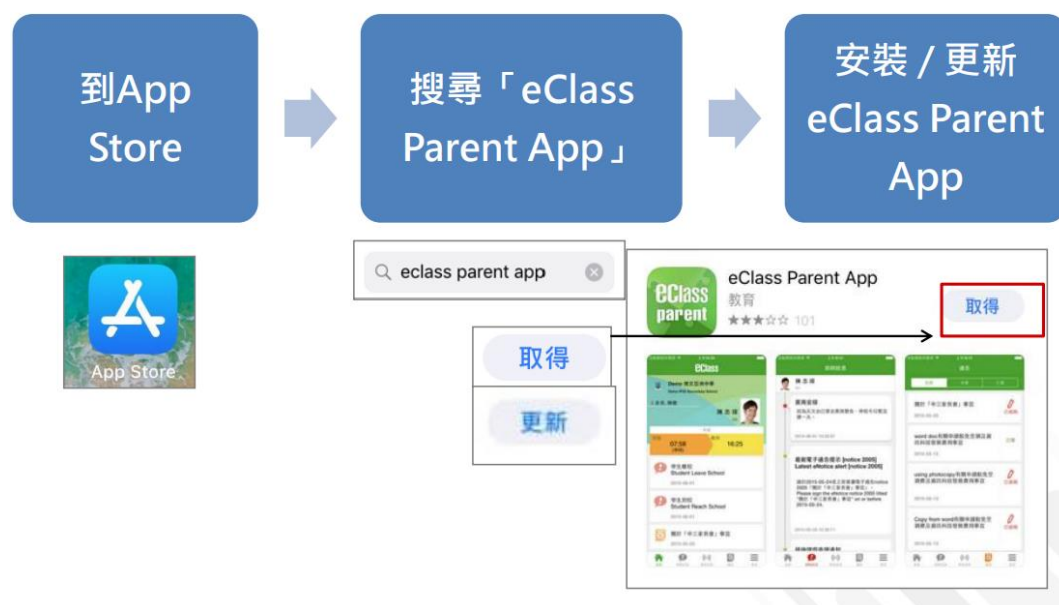

\*若 Android 手機不能於 Google Play 安裝 可到以下網址安裝 APK  
<https://www.eClass.com.hk/apk/>

\*\*\* 不同牌子 / 平台 / 版本的流動裝置或會有不同的設定方法。 \*\*\*

## 安裝 /更新部份 (HUAWEI)

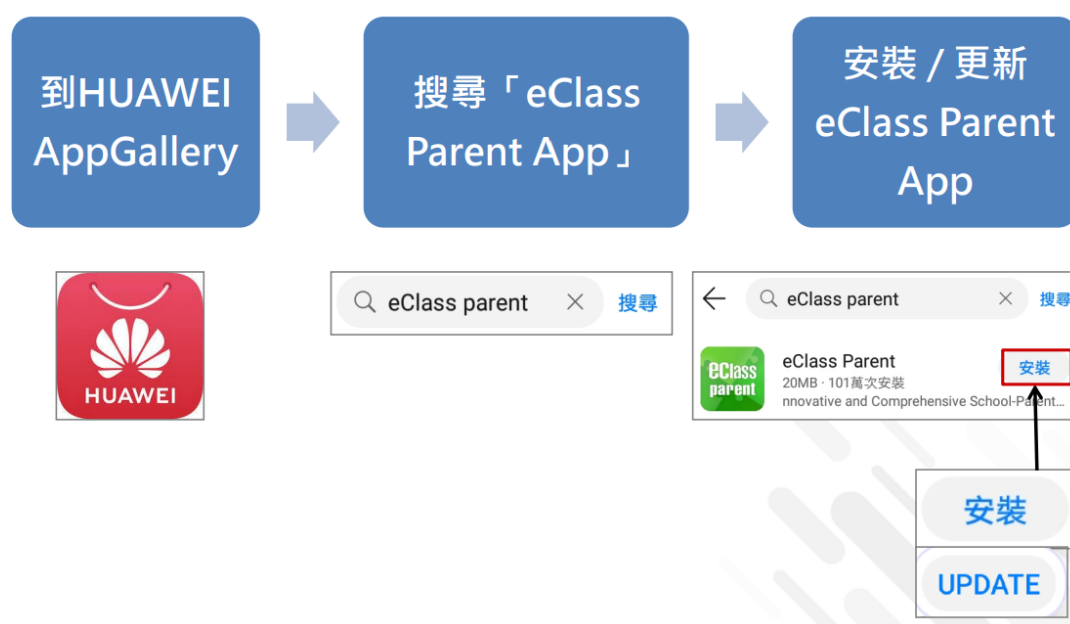

### 3. 健康申報(Health Declaration)[步驟 1-9]

	Android	iOS
1. 選擇 [健康申報]。		
2. 按 <b>+</b> 新增健康申報紀錄。		
3. 選擇記錄時間並輸入體溫。  * 只可新增當日體溫。		

	Android	iOS
<p>4. 選擇快速抗原測試結果。</p> <p>*只可新增當日快速抗原測試結果。</p>	 <p>The screenshot shows the '健康申報' (Health Report) screen for user 陳小柏 (Chen Xiaobai). The date is 2022年4月13日 (Wednesday). The temperature is 38.1 °C. The '快速抗原測試結果' (Rapid Antigen Test Result) is '陰性' (Negative). A red box highlights the '快速抗原測試相片' (Rapid Antigen Test Photo) button and the selection menu below it, which includes options for '陰性' (Negative), '陽性' (Positive), and '不適用' (Not Applicable).</p>	 <p>The screenshot shows the '健康申報' (Health Report) screen for user 陳圓圓 (Chen Yuanyuan). The date is 2022年4月12日 (Tuesday). The temperature is 36.5°C. The '快速抗原測試結果' (Rapid Antigen Test Result) is '- 請選擇 -' (Please select). A red box highlights the selection menu, which includes options for '陰性' (Negative), '陽性' (Positive), and '不適用' (Not Applicable), along with a '取消' (Cancel) button.</p>
<p>5. 亦可上載快速抗原測試相片。</p> <p>*只可新增當日快速抗原測試結果。</p>	 <p>The screenshot shows the '健康申報' (Health Report) screen for user 陳小柏 (Chen Xiaobai). The '快速抗原測試相片' (Rapid Antigen Test Photo) button is highlighted with a red box, and a photo of a YHLO rapid antigen test kit is being uploaded.</p>	 <p>The screenshot shows the '健康申報' (Health Report) screen for user 陳圓圓 (Chen Yuanyuan). The '快速抗原測試相片' (Rapid Antigen Test Photo) button is highlighted with a red box, and a photo of a YHLO rapid antigen test kit is being uploaded.</p>
<p>6. 然後按 [呈送]。</p>	 <p>The screenshot shows the '健康申報' (Health Report) screen for user 陳小柏 (Chen Xiaobai). The '呈送' (Submit) button at the bottom right is highlighted with a red box.</p>	 <p>The screenshot shows the '健康申報' (Health Report) screen for user 陳圓圓 (Chen Yuanyuan). The '呈送' (Submit) button at the top right is highlighted with a red box.</p>

